

The term 'IMPEESA' is actually reserved for our Chief Scout Lord Baden-Powell.

Impeesa
"The Wolf Who Never Sleeps"

'In the Matabele War 1896-97,' he claims, 'the enemy called me "The Wolf".' However, the meaning of his 'African name', 'Impeesa' or *impisi*, is closer to 'the animal that skulks by night': in other words, the hyena.

In 1887 we find BP in Africa, taking part in the campaigns against Zulus, and later against the fierce tribes of Ashanti and the savage Matabele warriors. The natives feared him so much that they gave him the name of "Impeesa", the "wolf-that-never-sleeps", because of his courage and amazing tracking abilities.

Camp Fire Poem

Did you ever watch the camp fire
When the wood was fallen low,
And the ashes start to whiten
Round the ember's, crimson glow?
Tell me, were you ever nearer
To the land of heart's desire,
Than when you sat there thinking
With your face turned towards the fire?



Dear Group Committee Members and Section Scouters:

On behalf of the Camp Impeesa – Camp Committee, we would like to thank your group for their participation and use of your Camp Impeesa.

Please use the enclosed manual as a resource to Camp Impeesa. Please ensure that any leaders using the camp are familiar with all policies and procedures.

This manual includes the following:

- Fee structure for buildings and sites
- Booking instructions
- Arrivals & Departures
- Facilities Available
- Camp Features
- Habits & Etiquette
- Tips & Traditions
- Camp Rules
- Adopt-A Campsite information and guidelines
- Site map of Camp Impeesa
- Evacuation plan & Directions to Woodstock General Hospital
- Directional maps to Camp Impeesa (HWY401 & HWY403)
- The Story of Drumbo Dan

ENVIRONMENT

As many more people use the outdoors for camping and hiking, we need to become increasingly aware of our impact on the environment. It is important for every Beaver, Cub, Scout, Venturer, Rover and Scouter to adopt an environmental ethic not just for Camp Impeesa, but for all outdoor activities. We must conduct ourselves in ways that will minimize our impact on the Camp and the natural world. We have an obligation to respect the rights of others to enjoy the outdoors so that its natural beauty will endure for future generations. If the outdoors is where our youth want to be, let's help them and the rest of the community learn how precious it is to us.

If anyone has any questions about Camp Impeesa, we would be happy to try to answer them. Please write us via email at campimpeesa@live.com.

Yours in Scouting

Camp Committee
Camp Impeesa

CAMP IMPEESA – FEE STRUCTURE

FEE SCHEDULE (REV-Aug 2010)

SITE	SCOUTING & GUIDING	NON-SCOUTING	BRANT & SWA AREA EVENTS	ADULT LEADER TRAINING
All Facilities (Whole Camp Rental)	Not Available (N/A)	Not Available (N/A)	\$2 per person per day	Not Available (N/A)
Beaver Lodge 2 night weekend	\$325	\$425	\$0	\$5/person - \$100 min.
Beaver Lodge Colony 1 night	\$190	N/A	\$0	N/A
Annikki Snow 2 night weekend	\$200	\$270	\$0	\$5/person - \$60 min.
Annikki Snow Colony 1 night	\$140	N/A	\$0	N/A
Mjr R. J. Black Cabin 2 night weekend	\$225	\$300	\$0	\$5/person - \$60 min.
Mjr R. J. Black Cabin 1 night	\$150	N/A	\$0	N/A
Week Day Evening Rental (outside – no building use)	\$1 per person to a max. of \$15	N/A	N/A	N/A
Picnic Shelter	\$50 per day \$80 per weekend	\$70 per day \$100 per weekend	\$0	\$15 per day \$25 per weekend or negotiable
Camping (Tent Sites)	\$2 per person per night – only if no buildings used	\$6.00 per person per night	\$0	\$2 per person per night – only if no buildings used
Adirondack	\$2 plus camping fee – only if no buildings used	\$10 per night plus camping fee	\$0	\$2 plus camping fee – only if no buildings used

***HST NOT INCLUDED (see next page for details of when it is applied)

**NEW – Scouting/Guiding Weekday Evening Use: contact Ranger – Dave Malcolm (519) 758-4233 prior to event to make usage arrangements.

BOOKING YOUR RESERVATION

All reservations are done on-line at <http://www.swoscouts.on.ca/campbookings1/> following the links to “Book a Camp” or by calling the South West Administration office (London) at 1-866-568-7472

A \$50 deposit is required for each building booked and a \$10 deposit for each camp site.

The deposit must be paid within 2 weeks to secure your booking.

Cancellations - all cancellations must be communicated to Camp Bookings Administrator by emailing (swocamps@scouts.ca) – If you cancel up to 4 weeks before your booking, you will be issued a full refund of the deposit. 4 Weeks or less, you will be charged the deposit. A cancellation of less than 48 hours ahead of booking will be charged the full amount. All reservations for buildings will be processed. No last minute cancellations.

HST - HOW IT IS APPLIED

2010/05/04

Application of Goods and Services Tax/Harmonized Sales Tax (GST/HST) in Respect of Camp Fees

The following outlines the GST/HST status of various types of camp fees, including the transitional rules for the implementation of Ontario and BC HST, and the HST rate increase in Nova Scotia.

GST/HST Status

Camp Type	Customers	GST/HST Status
Day camp, supervised	Members	Exempt where attendees are primarily (i.e. more than 50%) 14 years of age or under ¹
Day camp, supervised	Members	Taxable where 50% or more of attendees are over 14 years of age ²
Overnight camp, supervised	Members	Taxable ²
Day camp, unsupervised	Members	Exempt ³
Overnight camp, unsupervised	Members	Exempt ³
Day camp, supervised	Non-members	Exempt where attendees are primarily 14 years of age or under ¹
Day camp, supervised	Non-members	Taxable where 50% or more of attendees are over 14 years of age ²
Overnight camp, supervised	Non-members	Taxable ²
Day camp, unsupervised	Non-members	Exempt ³
Overnight camp, unsupervised	Non-members	Exempt ³

Explanation of Camp Types

Day camp, supervised – Day camp in which programs are administered for children. Attendees do not stay overnight.

Overnight camp, supervised – Camp in which programs are administered, and attendees stay overnight.

Day camp, unsupervised – Campground rental in which the customer does not stay overnight. Individuals or groups rent campsites. Scouts does not administer any programs for the customers. It is understood that Scouts has not filed an election to treat the rentals as taxable.

Overnight camp, unsupervised – Overnight campground rental. Individuals or groups rent campsites. Scouts does not administer any programs for the customers. It is understood that Scouts has not filed an election to treat these rentals as taxable.

¹ Schedule V, Part V.1, section 1 to Excise Tax Act (ETA)

² Schedule V, Part V.1, paragraph 1(f)(i) to the ETA

³ Schedule V, Part V.1, section 1 (exempt under the general rule) to the ETA

ARRIVAL PROCEDURES

1. Buildings and facilities will be open on arrival. Ensure you occupy only the facility(s) which you have reserved as others may arrive later than you with their booking agreement. There is no “on site” Ranger (though one may be on site on arrival). Contact the Property Manager or appropriate camp contact person (phone numbers posted) with any concerns or questions on arrival if you have a problem.
2. Unload your gear in the Unload area and then park vehicles in the designated parking area. Do not leave them in the unload area in consideration of other groups who may be in camp. Do not leave your vehicles parked at the buildings. Do not drive beyond the laneways and parking area unless given special permission by the Property Manager. We don’t want you to get stuck!
3. Pull carts are supplied and are available outside the maintenance Drive Shed. Gear is to be transported in by individuals. As Baden Powell says, “Hump Your Own Pack”. Return the pull carts to the Drive Shed once you are finished, allowing other groups to use the carts as well. Do not leave carts on sites.

DEPARTURE PROCEDURES

1. A Camp Ranger may be on site before you leave. Ensure when renting a building that you follow the clean up procedure check sheet that is left for you. He/ She will do a walk thru to ensure that all is completed.
2. Remember to leave it better and cleaner than you found it.
3. If your group has used any of the outdoor kybo’s, ensure they are cleaned better than found also.
4. If a Ranger is not in attendance before you leave, complete the Clean up procedure and leave the check sheet on the clip board provided.
5. Do not lock the doors or the front gate as a Ranger will be in at some point to do this.
6. Complete the Usage Report, supplying us with the total number of youth and adults that attended your event and leave on the clip board provided. This will be forwarded by the Property Manager to SWO Admin. for processing your invoice.

FACILITIES AVAILABLE

BEAVER LODGE

Beaver Lodge is so named for the many Beaver Colonies who have used and enjoyed this building for years. It is the hub of the camp and the largest of the three buildings on site. The main floor consists of an open lounge with a stone fireplace with a working fire insert wood stove. Firewood is provided in the wood box off the main deck. There is a large dining area with fully serviced kitchen with large fridge, freezer and stove including an 18L water cooler for your bottles. There is also a main floor washroom and a leader's / first aid room. The upper loft area has three rooms that will sleep up to 12 people. The basement has individual rooms with bunks to accommodate 28 people. Beaver Lodge is forced air heated and has upper and lower washrooms with flush toilets and working shower facilities. Beaver Lodge is located off of Ebor Field with nearby flag poles, Volley ball court and large camp fire ring.

ANNIKKI SNOW CENTRE

This vertical log cabin is so named after one of Brant Area's dedicated Cub Leader's Annikki Snow. Annikki was well known for her love of crafts and envisioned a building where her Pack could create countless hours of fun. This building is dedicated to her memory. It is a large 24' X24' open concept building with the main floor consisting of a fully serviced kitchen, dining and leisure areas. There is an upper loft for sleeping and a full basement consisting of an open area for use in training and craft building. There is hot and cold running water and a two piece bath in the basement. This building does not have shower facilities. It has electric heat as well as a wood stove with accessible firewood in the outside wood box. There are no bunks in the loft, so come prepared with ground covers and mats. Sleeping in the basement is not allowed due to fire code regulations. This building can accommodate up to 20 people. Annikki Snow Centre is located near the top of Ebor Field and cannot be accessed by your vehicle, especially in the winter. See procedure for carting your equipment to the building.

BLACK'S CABIN

This former Ranger's residence is so named in honour of Major R. J. Black, a very influential Scout Master and Brant District Commissioner who was a driving force behind the early days of Scouting in Brant. This open concept chalet contains a main floor kitchen, dining area, sleeping room, 3 pc bathroom and leisure area. There is an upper loft lounge area and sleeping room with an ensuite bath & shower. There are no bunks provided, so come prepared. The basement has an open area ideal for training & games as well as extra sleeping quarters with a walkout exit door. The kitchen has modern appliances with microwave and 18L water cooler. Black's Cabin is electrically heated and also has a wood burning fireplace with accessible firewood in the outdoor wood box. This building can also accommodate up to 20 people. Black's Cabin is located along the wood line near the Drive Shed, overlooking the forested ravine.

STU MURCHIE PAVILION

This open concept picnic shelter located at the side of Ebor Field directly across from Beaver Lodge is named in honour of former Scout Master, Venturer and Rover Advisor, Stu Murchie who was very influential in building the senior sections of Scouting in Brant and dedicated to the honour of Service. There are numerous picnic tables to use as well as two outdoor kybo's nearby. The pavilion also consists of a land line phone, electricity and lighting. There is an outdoor water tap nearby with seasonal access.

ADIRONDACKS

There are three Adirondacks (3 sided log cabins) located in the camp site areas among the trees. The Adirondacks were built with volunteer labour by active and former Brant Area Scout Groups (3rd Paris, 2nd Brant and 1st Burford) for the ease and enjoyment by all. Any group may use an Adirondack but must reserve them when booking a camp site. No cooking or open flame of any kind is allowed in these wood built structures. During winter camping, all bedding materials such as straw must be removed and not left behind. There are wood storage areas for your use but must be stocked before your departure for the next group to use.

CAMP FEATURES

Ebor Park Field This is the main field located off the parking lot and surrounded by Beaver Lodge, Annikki Snow Centre and Stu Murchie Pavilion. This large open field of grass is great for wide games, ceremonies, Area events and large scale camps. This area is named in honour of Brant's first scout camping facility, and Ontario's first Scout Master Training Centre. Ebor Park was once located along the banks of the Grand River near Brantford.

Normandale "Activity" Field This area of the camp is scheduled to be developed into an activity field with a reconstructed climbing wall, traverse wall, low ropes course and re-located obstacle course. Approval has been given to fundraise for the construction and we hope to have part of it available in 2011. This area is named in honour of Brant Area's former scout camp "Normandale", once located along the Lake Erie shoreline near the village of Normandale, ON.

Mark Gilbert Memorial Field This field is named in memory of Mark Gilbert, a dedicated Brant Area scout who passed away while doing what he enjoyed most, canoeing with his Scout Troop. This field is primarily an open activity field. There is a baseball back screen located here for your groups use. Bats, helmets, balls, bases and some gloves are available on request however it is recommended that you encourage your youth to bring their own equipment.

Peacehaven This is the newest addition to our camp. This area of the camp was formerly known to be a forest regeneration area where camping was restricted to allow the undergrowth to succeed. It has grown to a lush, peaceful wooded area, carpeted with beautiful white trilliums in the spring. The Peacehaven trail extends from just behind the Annikki Snow Centre, through the forest to the camp sites beyond the pond. There is a rare Shag Bark Hickory tree located here. Have your youth try to find it... This area is named in honour of our former brother camp "Peacehaven" located near Drumbo, ON.

Zip Line Our former zip line located behind the Drive Shed has been decommissioned and we have been given approval to develop and reconstruct a new one. Look for this to be completed in 2011.

Friendship Trail Located to the right of the main gate, this pathway extends along the perimeter of Ebor Field, along the ridge by the Memorial Campfire and into Normandale Field. During the winter months the trail extends thru the frozen swamp and into Mark Gilbert Field. It is hoped that a group adopts this as a work project to fully extend the trail around the entire camp property. This trail will soon be named in honour of two best friends who have passed - former Camp Impeesa Property Manager, Rick Johnston and Camp Committee Member, Jack Ryder. Both dedicated former Brant Area Scout Leaders who worked tirelessly on the formation of Camp Impeesa. It is fitting that their love for Camp Impeesa surrounds our entire camp.

Drumbo Dan The legend of Drumbo Dan has a long and storied past. There is a head stone located in the swamp between Normandale Field and Mark Gilbert Field that honours this story. The search to find it can be as fun as the story itself. You can find a copy of the story in this manual.

Ralph Hight Memorial Chapel Our chapel is built in the valley of a natural theatre that echoes spirituality throughout the trees. Steps lead in two directions from the laneway near Black's Cabin to the chapel below, allowing a very ceremonial entrance to this sanctuary. The chapel is named in honour of a very popular Scout Master from Brant Area. The lectern and cross are also named in honour of Brant Area Scouting youth who have passed on.

Memorial Camp Fire Theatre The formal camp fire theatre has ample seating for large groups and a stone hearth for elaborate formal camp fires. There are two entrances to the theatre. The formal entrance way extends from the trail to Normandale Field winding its way through the trees. The rear less formal entrance is located at the top of the hill at the end of Ebor Park Field. A fire pit for ashes is located in the tree line behind the seating area. No cooking of food is allowed and all fire wood, candles, decorations or ceremonial supplies must be removed.

The Story Tree This Colony feature is located along the edge of Normandale Field and features a large old cedar with a whimsical forest friend face. There is seating designed low to the ground for our young youth and a large chair to recite a story from. The entrance is designed so that all who are taller than the average Beaver age youth must duck to symbolize the need to be 'down to their level' in mind, body and spirit.

Council Rock This Pack feature is located along the trail to Normandale Field and features a formal entrance way to a large open circle in the woods with an elevated rock outcropping. There is primitive log seating for the youth and is an excellent spot for formal Pack gatherings. This feature is dedicated in honour of former Brant Area Pack Scouter, Chuck Purser who passed away doing what he loved best – Scouting.

Memorial Features There are numerous memorial plaques located at different spots all around the camp in honour of those Scouting youth and adults who have passed and loved the game of Scouting. Have your youth count how many they can find in a fitting tribute to their memory.

HABITS & ETIQUETTE

Accidents/Incidents Minor accidents may be treated at any of the buildings, each containing a First Aid Kit. In the event of an emergency, CALL 911 to request Fire, Ambulance or Police. Phones, located in all buildings, are on the same phone line. Accident forms are to be completed for any injury requiring outside medical care or assistance. These forms are kept near the First Aid Kits. One copy goes with the Leader, two stays with the camp for camp records and forwarding to SWO Administration.

Buildings All buildings used must be kept clean and tidy – FOR YOUR SAFETY. At the conclusion of the Camp, buildings must be cleaned; fireplace cleaned & ashes removed; no food left; refrigerators/freezers empty; surrounding grounds clean; windows and doors shut. A closing Ranger will be on site before or after you leave to check premises.

Tent Sites ‘No Trace Camping’ applies to the entire camp. Designated tent sites are adopted by Scouting Groups to maintain. Storage for wood must be restocked before departure and entire area left better and cleaner than was found with reusable equipment neatly stacked or stored. Each site has its own picnic table. Please return all borrowed items.

Camp Fires All fire pits must be emptied of ashes (see map for closest Ash Pit) and dowsed with water. NEVER LEAVE CAMP WITH BURNING EMBERS OR FIRE IN FIRE PITS – THESE ARE NOT CHECKED AFTER YOU LEAVE. The location of firefighting equipment in the buildings should be noted when you arrive. Personal firefighting equipment must be readily available on all tent sites.

Kybos There are numerous earthen toilets or ‘kybos’ located around the camp. It is expected that if your group members use these, that they ensure they are cleaned before you leave camp. This is important as they are not checked after a group’s departure. It is also recommended that you bring toilet paper as the supplied stock may be depleted.

Vehicles All vehicles must be left in the designated parking area. Only vehicles carrying food supplies to and from the buildings are allowed. These must be returned to the parking lot as soon as they are unloaded. Please reserve the unloading area for unloading equipment and re-park as soon as possible.

Bikes No motorized bikes or ATVs are allowed at camp. Mountain bikes must only be used on established trails ensuring not to damage the environment.

Damage As a point of honour, report and make good any damage done during your camping period. We rely on your report to help us correct any damage before the next renters arrive.

First Aid The first aid equipment in the buildings is available for use by any responsible person at any time. Please note on your clean up report when supplies have been used and replacement is required. All Accidents and Incidents should be reported and copies left on site for follow up (see above).

Controlled Burning The large open gravel pit located in Normandale Field is typically used as an archery range. During the Winter months, groups who use straw for bedding can take it there and do a controlled burn before they leave camp. Remember to not leave a fire unattended and it must be extinguished before you leave camp.

Better than you found it! As an integral part of all Scout Camps, it is expected that each group of campers will leave the campsite better than they found it, by including in their program time for a camp good turn. Projects can be assigned by notifying the Camp Property Manager. Please note your accomplishments on your report for recognition purposes.

Flag Etiquette Flags are supplied for the Camp Flag Poles and are available on request from the Property Manager. Proper ceremony must be observed regarding the raising and lowering of flags at appropriate times. All hoisting camp flags must be returned to Beaver Lodge. Standing flags and stands must also be returned to Beaver Lodge located in the main hall.

Fields Ebor Park, Normandale Field (named after former Brant Area Scout Camps) and Mark Gilbert Memorial Field require regular ground maintenance and grass cutting. Help to remove branches, rocks and debris by walking fields following your visit or use of these areas.

TIPS & TRADITIONS

- Bring your own linen. There are no dish or bath towels available.
- Recycle all plastic, paper & glass and take with you. There is no on site program.
- Garbage bags are supplies in all buildings – please compact your garbage and place in dumpster in parking lot. Ensure the lid is down to keep pests out.
- Camp Bell (located on between Beaver Lodge and Black's Cabin) use:
 - Flag break & lowering – 3 sets of double rings
 - Chapel call – 10 times
 - Emergency – continuous ringing, quickly and loudly
- Travel to and from camp in uniform.
- Pull carts are available for gear and are located against the east outside wall of the Drive Shed. Please return them as soon as possible for the next group – do not leave on your site.
- Flags lowered at sunset, raised in morning
- Leave knives and hatchets outside Chapel

CAMP RULES

1. No cutting of standing trees
2. No ground fires except in designated areas
3. 'No Trace' camping applies.
4. No Smoking in any building or around youth – field strip your cigarette butts and pack them out.
5. No alcohol allowed on site (entire facility)
6. No pets allowed. Only Assistance Dogs for hearing and sight impaired are permitted.
7. Personal hygiene required.
8. Accidents and/or Incidents must be reported.
9. No camping in 'Feature' areas (i.e. – Chapel, Council Rock, etc)
10. All camp sites must be booked to ensure you are not evicted by another reservation.

ADOPT-A-CAMPSITE PROGRAM

This program was implemented a few years ago. It started out as a trial program in order to develop the part of the camp north of the pond. Groups wanted a special place they could always call home when they camped at Camp Impeesa, especially during Area Events. They wanted to set up gateways with group recognition and make site improvements for their enjoyment on future outings. It was decided to structure some rules in adopting a site so that they are maintained to a standard and should that standard fall; the site would be turned over to another group to adopt. Anyone can use a site at anytime but are expected to leave it as they found it in respect for the group who has adopted it as their camp home. All sites are booked on-line when you book your reservation and are listed and referenced by number (see map) and not the adopting group's name, as they do change from time to time. Many sites are equipped with picnic tables and camp kitchen structures. Please leave them as you found them and do not move to another site. Here are the guidelines to adopt a permanent campsite:

1. No standing trees, DEAD OR ALIVE, are to be cut or trimmed.
2. Pioneering projects will not require dismantling, provided they are well built, neat in appearance and maintained (as judged by the camp committee or a representative).
3. String, twine and/or rope, is not to be used to fence off campsite boundaries.
4. Fire pits to be cleaned before departure. Fire bins to be cleaned and stored in the storage area. No ground fires, except in approved fire pits. Ashes from the fires to be doused and dumped in the cinder area. A permanent campfire ring will be established at each site as soon as possible.
5. Carving upon or marking of boundary stakes and/or the trees, is prohibited.
6. Spars that are marked are not to be burnt and be stored in the spar port when not in use.
7. All garbage to be taken with you on departure.
8. No vehicles are allowed in the camp site area. All gear must be carted or carried in.
9. Your site belongs to your entire group and not just your section (ie. Troop).
10. Sites to be inspected by the Camp Committee on a regular basis. If guidelines are not followed, the designated person from that group will be notified. If the problem persists, the group will lose their camp site adoption and it will be offered up to another group.
11. Any damages are to be reported to the Camp Committee.
12. Camp sites are adopted on a 3 year basis with annual renewal available.
13. Each and every campsite may be booked at any time by any group unless previously booked by adopting group.
14. All campsites are charged a booking fee regardless of adoption.

***To adopt a camp site please contact Volunteer Property Manager, Dave Malcolm at campimpeesa@live.com

LIST OF CURRENT ADOPTED CAMP SITES

AS OF JANUARY 7/11

ONE – available
TWO - 20TH BRANT FAITH
THREE - available
FOUR – 1ST PARIS
FIVE – available
SIX – 1ST SOUTH BRANT
SEVEN – 1ST WATERFORD
EIGHT – 1ST AYR
NINE – 5TH BRANT CEDARLAND
TEN – available
ELEVEN – 48TH BRANT BALFOUR
TWELVE – available
THIRTEEN – 10TH BRANT BANBURY
FOURTEEN – available
FIFTEEN – 38TH BRANT ST. MARKS

LIST OF CURRENT ADOPTED ADIRONDACK SITES

AS OF JANUARY 7/11

'A' ONE - available
'A' TWO – 2ND BRANT TRINITY
'A' THREE – 48TH BRANT SCOUTS

map of SCOUTS CANADA - BRANT AREA - CAMP IMPEESA

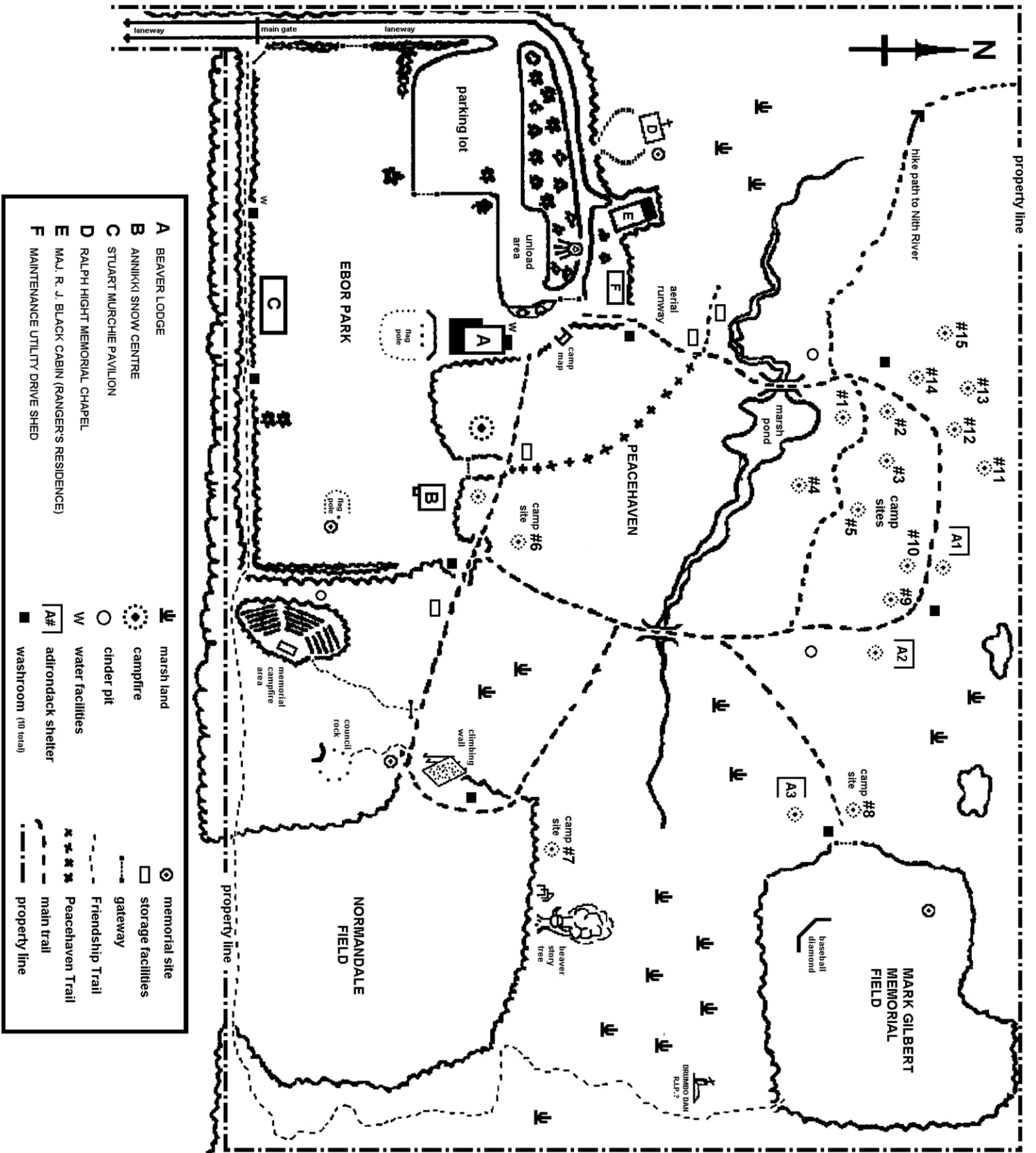

NOTE - MAP IS NOT TO SCALE

REVISION #5 09/06/10
DAVE MALCOLM

EMERGENCY CONTACT INFORMATION

FIRE, AMBULANCE & POLICE

CALL 911

CAMP LOCATION:

#827559, Township Road #8, Drumbo, ON

Township of Blanford – Blenheim, Oxford County

Camp Impeesa - All Buildings _____ 519-632-7606

Woodstock General Hospital _____ 519-421-4211

Poison Control, Woodstock _____ 1-800-268-9017

Drumbo Volunteer Fire Department _____ 1-877-537-6277

Willet Hospital Paris (Urgent Care) _____ 1-519-442-2251

Camp Impeesa - Volunteer Property Manager

Dave Malcolm _____ (cell) 519-758-4233 or (work) 519-756-1647









Scouts Canada - South West Ontario Admin. Centre _____ 1-866-568-7472

Scouts Canada – Manager of Properties & Facilities – Ontario - Brian Moore__ (cell) 519-865-8120

EVACUATION PLAN:

IN CASE OF EMERGENCY – FIRE, FLOOD, TORNADO, HEAVY WIND, ETC. – ALL PERSONS TO REPORT TO THE STU MURCHIE PAVILION (PICNIC SHELTER) – SOMEONE WILL SOUND THE BELL CONTINUOUSLY FOR SEVERAL MINUTES TO ALERT ALL CAMPERS.

Directions to nearest Hospital to Scouts Canada, Camp Impeesa.

Directions	Distance
Total Est. Time: 30 minutes Total Est. Distance: 19.09 miles	
START 1: Start out from CAMP IMPEESA, 827559 Township Road 8, Drumbo, ON , by going WEST on TOWNSHIP RD 8 toward BLENHEIM RD (Portions unpaved).	0.7 miles
 2: Turn LEFT onto BLENHEIM RD.	0.8 miles
 3: Turn RIGHT onto DRUMBO RD / CR-29. Continue to follow CR-29.	4.9 miles
 4: Take the HWY-401 W ramp toward LONDON.	0.2 miles
 5: Merge onto PROVINCIAL ROUTE 401 W.	7.2 miles
 6: Merge onto CR-2 W / PROVINCIAL ROUTE 2 W via EXIT 238B toward WOODSTOCK.	1.1 miles
 7: Turn RIGHT onto CR-4.	0.8 miles
 8: Turn LEFT onto CR-35.	1.1 miles
 9: CR-35 becomes DEVONSHIRE AVE.	1.7 miles
 10: Turn LEFT onto RIDDELL ST.	0.2 miles
END 11: End at WOODSTOCK GENERAL HOSPITAL, 270 Riddell Street Woodstock, ON	



Start: **SCOUTS CANADA, CAMP IMPEESA, 827559 Township Road 8, Drumbo, ON**

End: **WOODSTOCK GENERAL HOSPITAL, 270 Riddell Street, Woodstock, ON**

DIRECTIONS to Camp Impeesa from Highway #401

HWY#401 TO EXIT 250 (DRUMBO), TRAVEL EAST BOUND ON DRUMBO ROAD THRU TOWN OF DRUMBO TO BLENHEIM ROAD. TURN LEFT (NORTH BOUND) TRAVEL 1KM TO TOWNSHIP ROAD #8, TURN RIGHT (EAST BOUND). TRAVEL APROX. 1.5KM TO CAMP IMPEESA LANEWAY ON LEFT. LOOK FOR SCOUTS CANADA SIGN AT MAIL BOX.

Camp Impeesa, 827559 Township Rd #8 Blandford-Blenheim Township

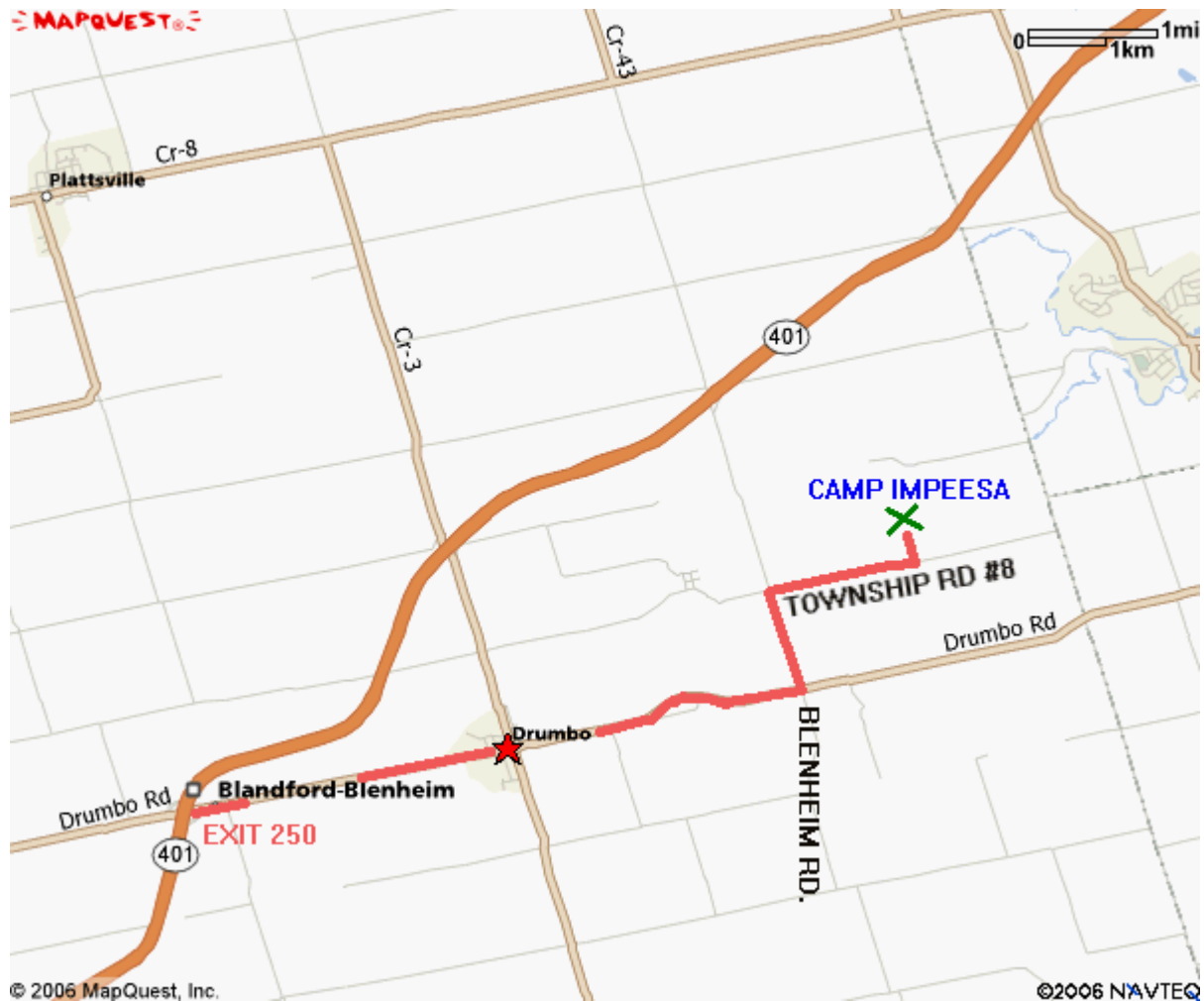

DIRECTIONS to Camp Impeesa from Highway #403

Take Hwy #403 to Rest Acres Rd. (exit#27); travel north bound to Paris; turn left on King St. (Hwy#99) - travel west bound to Falkland; turn right at Puttown Road - travel north to Stop sign (Puttown Rd becomes Brant-Oxford Road); thru stop to first side road to the left (Township Road #8, Wolverton 4km) - travel West bound for approx. 2 km; look for Scouts Canada sign over Mail Box; turn right down long lane to Camp Impeesa.

Camp Impeesa, 827559 Township Rd #8 Blandford-Blenheim Township

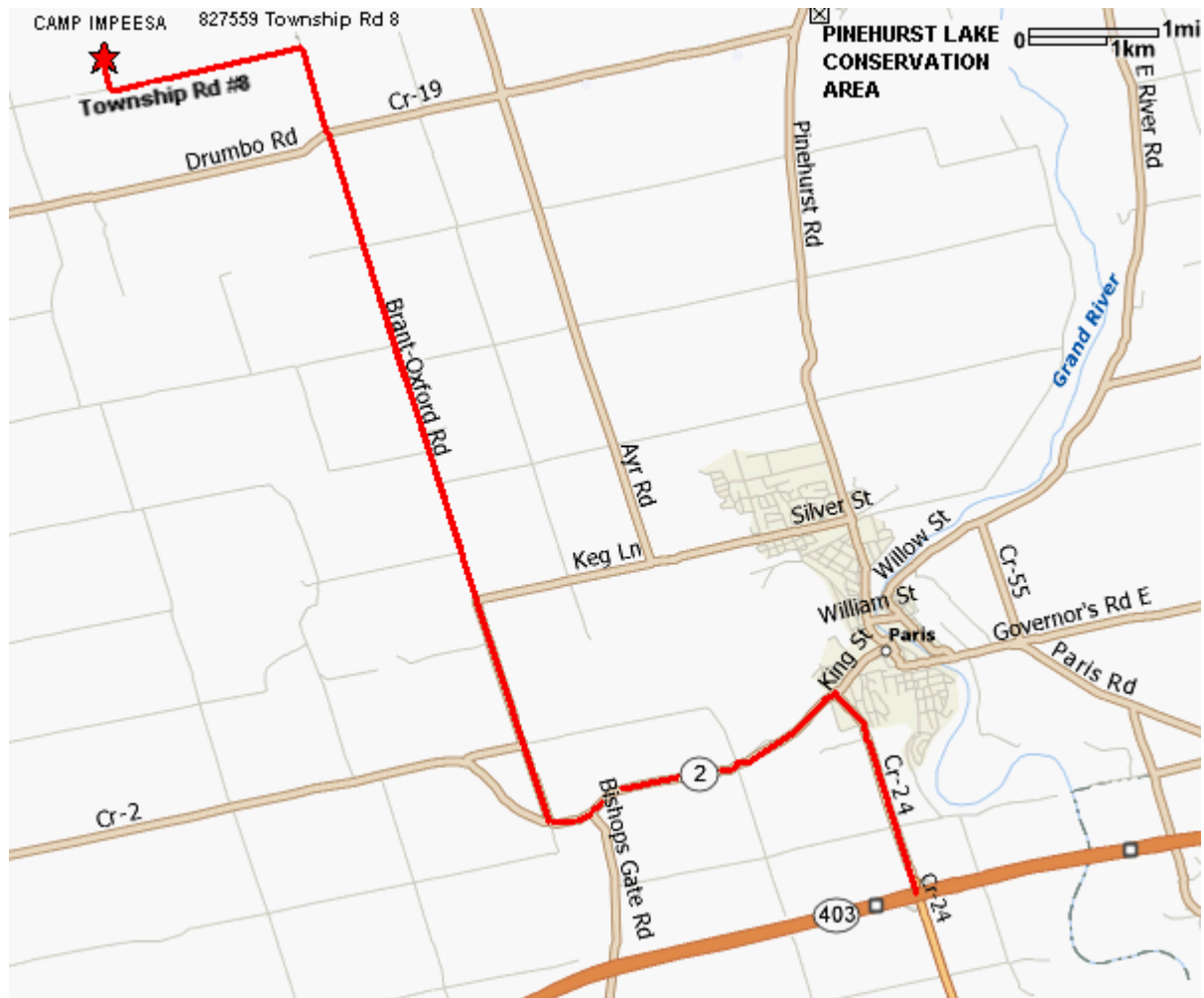

The Outdoor Code

As a Scout, I will do my best to:

- **Be clean in my outdoor manners.**
I will treat the outdoors as a heritage.
I will take care of it for myself and others
I will keep my trash and garbage out of lakes, streams, fields, woods, and roadways.
- **Be careful with fire.**
I will prevent wildfire.
I will build my fires only where they are appropriate.
When I have finished using a fire, I will make sure it is cold out.
I will leave a clean fire ring, or remove all evidence of my fire.
- **Be considerate in the outdoors.**
I will treat public and private property with respect.
I will use low-impact methods of hiking and camping.
- **Be conservation minded**
I will learn how to practice good conservation of soil, waters, forests, minerals, grasslands, wildlife, and energy.
I will urge others to do the same.



The Tale of DRUMBO DAN - The Ghost of Impeesa -



Some time ago, in this great land,
There was a trapper by the name of Dan.

He made his living selling hides.
His goods were the best, know far and wide.

Then one dark night, around Halloween,
People asked about Dan, for he hadn't been seen.

Some folks heard he drown in the Nith or the Grand.
While others heard he moved to Newfoundland.

But the real and true story, as you will hear,
Is that Dan was attacked by a huge Grizzly Bear.

The attack was quite gruesome and so it's been said.
The Bear chewed off Dan's feet and left him for dead.

Old Dan was in trouble, his time was now done.
Alone in the woods with no 9 1 1!

Dan died that same night, from severe loss of blood.
And the rain came so hard there was a huge flood.

This is why some folks say that poor Dan had drowned.
They all take the true story and turn it around.

Not to frighten the children of Drumbo they say,
But the truth should be told, its better that way.

Now Dan went to heaven, to the Pearly Gate.
But St. Peter said, I'm afraid you must wait.

You see he had noticed Dan's two missing feet.
He said, "Dan, I'm sorry but you're just not complete."

He sent Dan back down to the place he had died.
A place known as Drumbo and the lands near beside.

These lands called Impeesa, where the Scout Camp is found.
They say Dan is there, and just wanders around.

He must have two feet to enter the gates,
So for years now, Old Dan just sits back and waits.

For someone with feet that are just the right size.
So that Dan's eternal peace can be finally realized.

Now Dan was a small man about four eleven,
So therefore he's looking for kids over seven.

The last time I heard he wore a size three,
But let's think about this between you and me.

If you were hunting for feet the right size,
Don't you think that it would really be wise?

To find a camp with lots of young campers,
And cut off their feet, and throw them in hampers.

To try later on to see which ones were right?
And the best time to do this would be darkest of night.

Old Dan might do this if we give him the chance
He'll cut off your feet – the end of your dance.

Now that is the TRUE tale of our Drumbo Dan.
A trapper when living, now a ghost of a man.

Like I said, Old Dan is most active at night,
But if you walk alone in the broad day light,

You might make him think that it would be quite neat,
To finally find those two 'just right' feet.

So remember that any time you camp out here,
Drumbo Dan is still searching, he may be near.

He needs those two feet to end his career,
As the GHOST OF IMPEESA, and his reign of FEAR!

-Anonymous